



CONRAD HONG KONG

CONRAD[®]
HONG KONG

NEVER JUST STAY. STAY INSPIRED.

Hotel Location

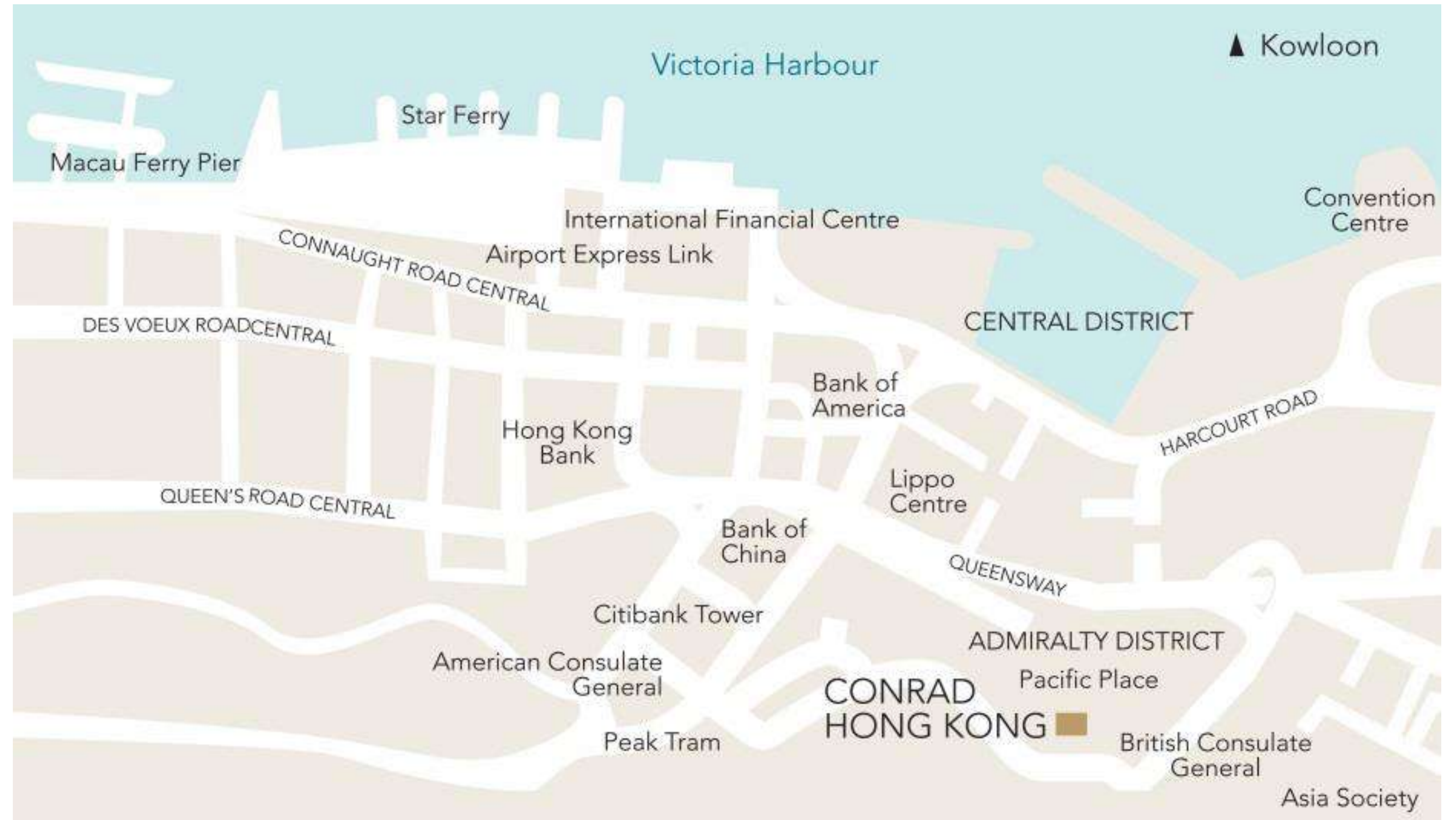

- Conveniently located in central business district; towering 61 floors above Pacific Place
- Close proximity to Hong Kong Convention & Exhibition Centre and Macao Ferry Pier
- 30 minutes drive to Hong Kong International Airport
- 15 minutes away from Airport Express Hong Kong Station
- 4 minutes ride from Hong Kong Ocean Park by the MTR South Island Line

Hotel Location - Exterior





DELUXE ROOM

- Located from 40th - 53th floors
- 512 spacious rooms including 45 suites
- 452 sq ft
- Deluxe room with views of city skyline
- 19 non-smoking floors



DELUXE PEAK VIEW ROOM

- Located from 40th - 53th floors
- 512 spacious and elegantly appointed rooms with LCD TV, internet access
- 452 sq ft
- Rooms with views of Victoria Peak
- 19 non-smoking floors



DELUXE HARBOUR VIEW ROOM

- Located from 40th - 53th floors
- 512 spacious and elegantly appointed rooms with LCD TV, internet access
- 452 sq ft
- Rooms with views of Victoria Harbour
- 19 non-smoking floors



ONE-BEDROOM SUITE

- 754 sq feet
- One-bedroom suite with views of Victoria Harbour or Peak
- Separate living room and a bedroom



ONE-BEDROOM SUITE

- Separate living room and a bedroom



EXECUTIVE LOUNGE

- Exclusive services including private check-in, butler service
- complimentary full breakfast, afternoon tea and evening cocktail at the Executive Lounge on 59th floor

Meeting Capacity Chart

Room	Area		Dimensions		Height		Capacities					
	Sq m	Sq ft	Metres	Feet	Metres	Feet	Classroom	Theatre	Banquet	Reception	Dinner/Dance	U-shape
Chatham	151	1,625	13.7 x 14	45' x 46'	2.7	9'	88	180	108	180	-	36
Hennessy	145	1,560	13.4 x 14.3	44' x 47'	2.7	9'	72	150	96	150	-	35
Stanley	34	370	4.3 x 9.1	14' x 30'	2.7	9'	16	24	24	30	-	12
Salisbury	34	370	4.6 x 8.2	15' x 27'	2.7	9'	16	24	24	30	-	12
Tai Tam	34	370	4.6 x 8.2	15' x 27'	2.7	9'	16	24	24	30	-	12
Humphrey	34	370	4.3 x 8.5	14' x 28'	2.7	9'	16	24	24	30	-	12
Bowen	86	930	12.8 x 7	42' x 23'	2.4	8'	48	80	72	80	-	30
Kennedy	52	560	7.3 x 7	24' x 23'	2.4	8'	24	45	48	45	-	17
Caine	49	530	7.3 x 7	24' x 23'	2.4	8'	24	40	36	40	-	17
Barker	26	285	4.9 x 7	16' x 23'	2.4	8'	8 (Boardroom)					
Robinson	17	180	5.2 x 3.7	17' x 12'	2.4	8'	8 (Boardroom)					

Room	Area		Dimensions		Height		Capacities					
	Sq m	Sq ft	Metres	Feet	Metres	Feet	Classroom	Theatre	Banquet	Reception	Dinner/Dance	U-shape
Grand Ballroom	767	8,242	20 x 46.6	64' x 153'	4.5	15'	400	700	624	1000	516	90
Granville	231	2,484	20 x 14	63' x 46'	4.5	15'	84	200	132	250	96	40
Nathan	311	3,344	20 x 21	65' x 69'	4.5	15'	124	300	180	400	144	48
Harcourt	225	2,414	20 x 14	64' x 46'	4.5	15'	84	200	132	250	96	40
Nathan + Granville	542	5,828	20 x 31	63' x 93'	4.5	15'	208	500	384	650	312	78
Harcourt + Nathan	536	5,758	20 x 31	63' x 93'	4.5	15'	208	500	384	650	312	78



Floor Plan - Grand Ballroom

Grand Ballroom
(Lower Lobby Level)
Flexible setup - can be
divided into three
sections, accommodating
40 to 700 persons

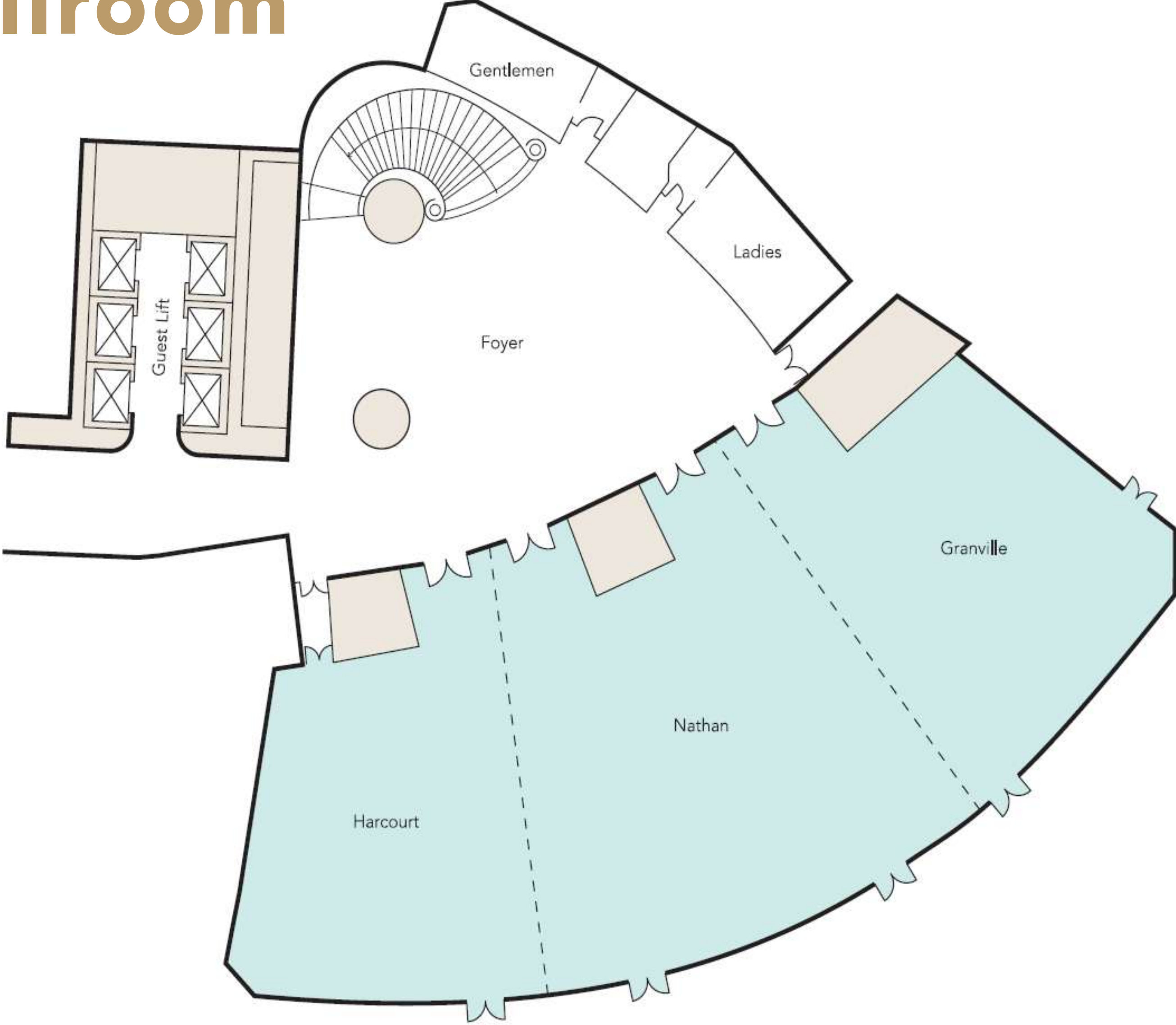

Floor Plan - Dedicated Meeting Floor

Dedicated Meeting Floor
on Level 7 - Total of 11
meeting rooms, with 7
rooms enjoying natural
daylight - accommodating
6 to 180 persons

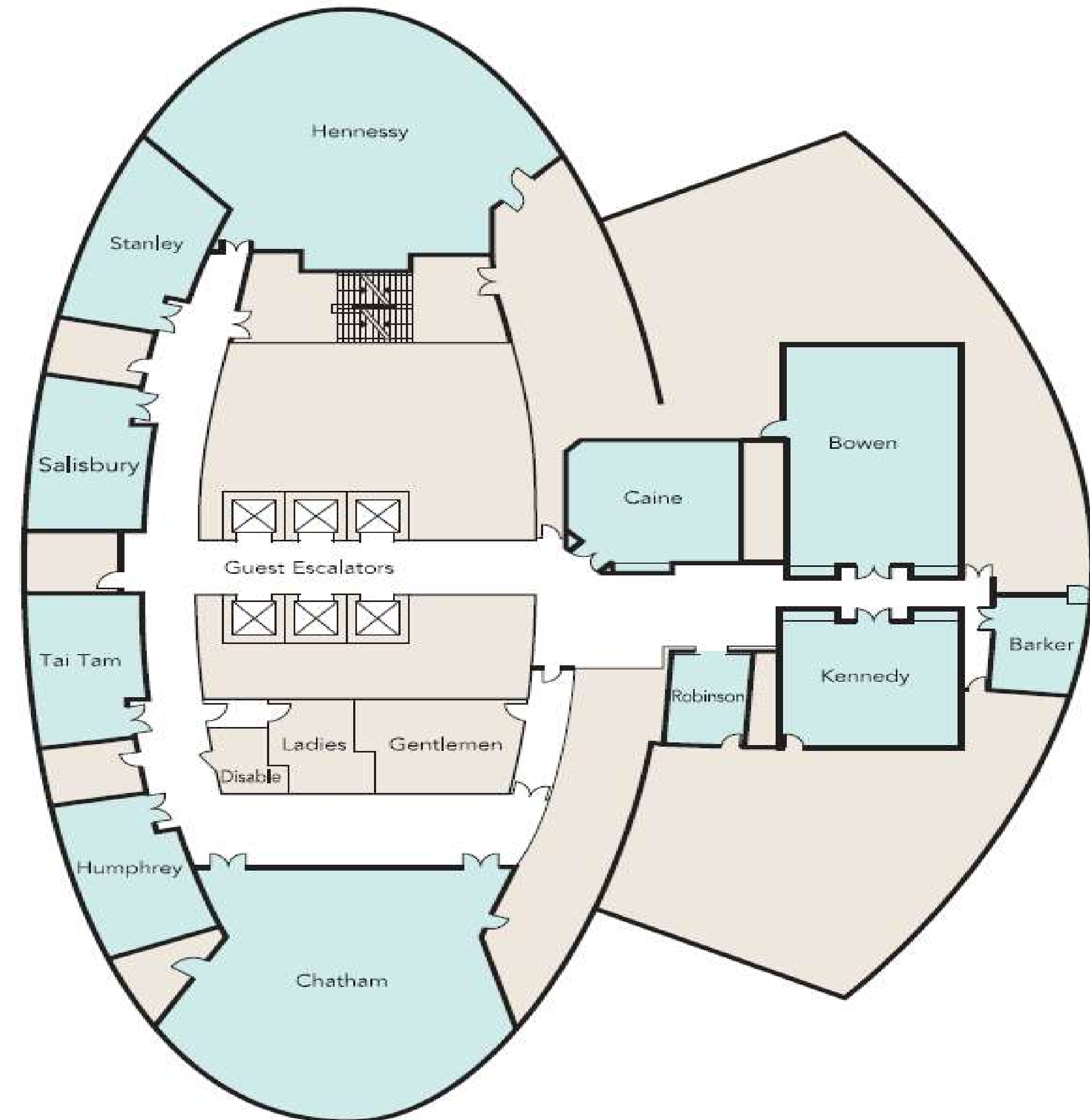



GRAND BALLROOM - THEATRE STYLE

- Satellite and video conferencing available
- Latest audio-visual and technical facilities
- Wired and wired high speed internet access



BALLROOM FOYER

- Spacious foyer space with direct access the Grand Ballroom for versatile event setup, installation or food stations.
- Lavish space for mingling as coffee-break or pre-meal cocktail venue



CHATHAM ROOM

- Meeting room with U-shaped set up
- Room with natural day light
- 1,700 sq ft for a maximum of 36 persons



BOWEN ROOM

- Meeting room with U-shaped set up
- 980 sq ft for a maximum of 48 persons



HENNESSY ROOM

- Meeting room with banquet set up
- Room with natural day light
- 1,549 sq ft for a maximum of 96 persons



HENNESSY ROOM

- 7 meeting rooms with floor-to-ceiling window



SALISBURY ROOM

- Four function rooms with ceiling-to-fall window featuring natural daylight and vibrant cityscapes
- flexible for boardroom, roundtable and classroom setup



CAINE ROOM

- Half-Moon Setup
- Versatile for Private luncheon/ Dinner setup (2 round tables of 12 guests)

Restaurants & Bars

Lobby Lounge



Garden Café



Brasserie on the Eighth



Golden Leaf



Nicholini's



Pacific Bar



5 Reasons to Stay with Us



Luxury hotel with the philosophy of providing flawless service to guests

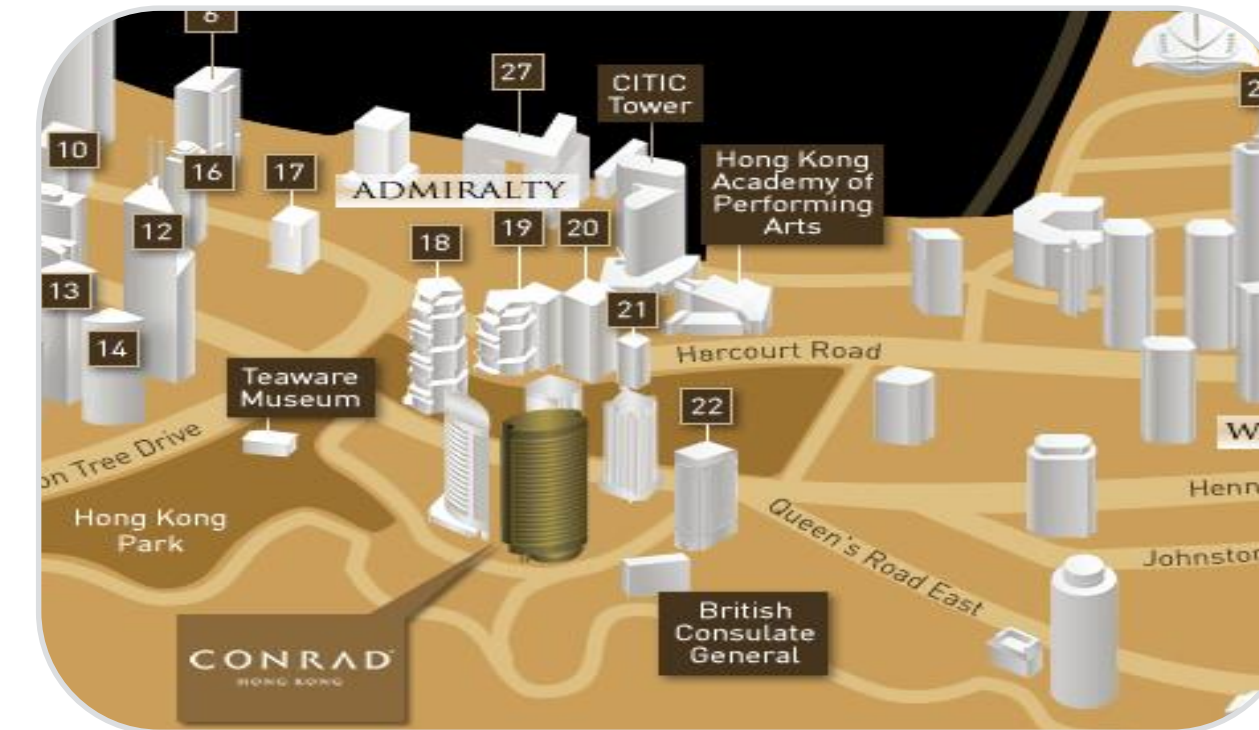

Conveniently located in the heart of the central business district



Stunning views of Victoria Harbour and The Peak



Award-winning restaurants



Experience local culture to the full extent